

SCHEMA DI MONTAGGIO - ASSEMBLY



-1)



-2)



-3)

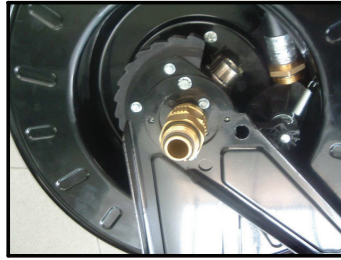

-4)



-5)

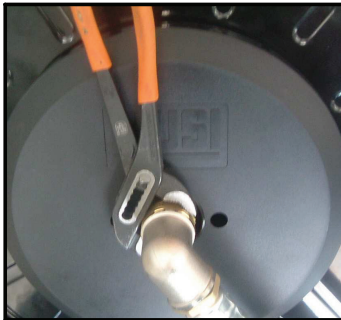

-6)

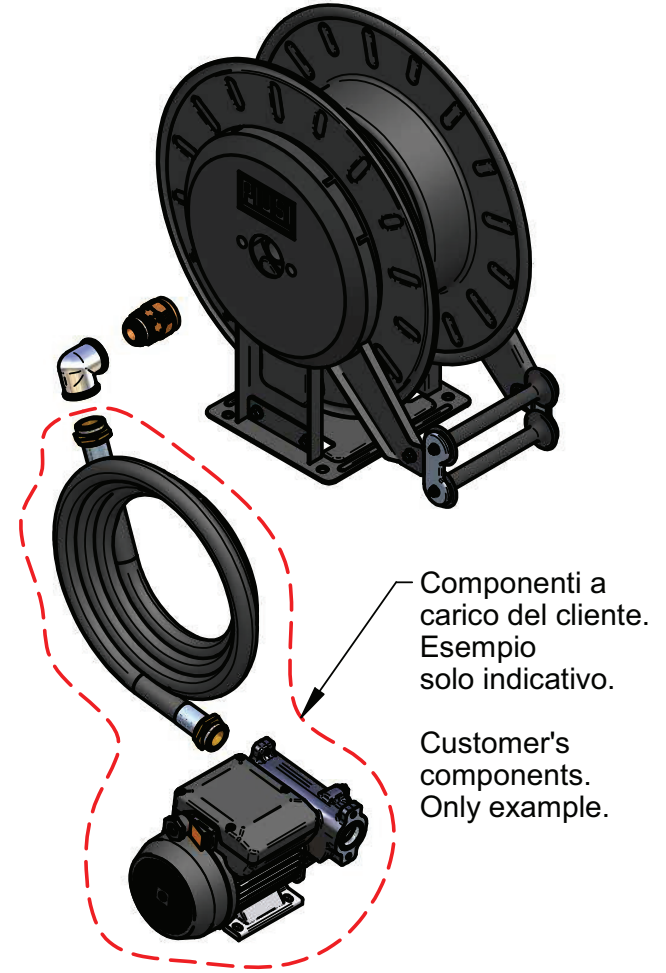

Componenti a carico del cliente.
Esempio solo indicativo.

Customer's components.
Only example.

ENGLISH (Translated from Italian)

A INDEX

Table with 2 columns: Symbol and Description. Includes categories like MACHINE AND MANUFACTURER IDENTIFICATION, SAFETY, TECHNICAL DATA, and PERFORMANCE SPECIFICATIONS.

B MACHINE AND MANUFACTURER IDENTIFICATION

Product identification section including available models (By-pass 3000, Carry 3000), product code, technical data, and manufacturer information (PIUSI S.p.A.).

C DECLARATION OF INCORPORATION OF PARTLY-COMPLETED MACHINERY

Legal declaration text stating the manufacturer's responsibility for the partially-completed machinery, including model and CE marking information.

H1 TECHNICAL DATA

Table with 2 columns: Functioning Point and Performance Data. Lists flow rate, pressure, and other technical specifications for different operating points.

D MACHINE DESCRIPTION

General description of the pump, highlighting its self-priming, volumetric, rotating vane design and various motor options.

D1 MOVING AND TRANSPORT

Instructions regarding the limited weight and dimensions of the pumps, and special lifting equipment requirements.

E GENERAL WARNINGS

- Important safety warnings including: ensure operation safety, use correct lifting equipment, avoid contact with moving parts, and use proper disposal methods.

ENGLISH (Translated from Italian)

F FIRST AID RULES

Instructions for first aid in case of electrical shock, including steps to take to ensure safety and seek medical attention.

G GENERAL SAFETY RULES

- Essential protective equipment characteristics: wear protective gear, avoid contact with moving parts, and use proper handling techniques.

H2 PERFORMANCE SPECIFICATIONS

Performance diagram showing flow rate as a function of back pressure, with a table for typical delivery configurations.

M INSTALLATION

- M1 PRELIMINARY INSPECTION: Verify all components are present and correct. M2 POSITIONING THE PUMP: Ensure correct orientation and secure attachment.

M3 NOTES ON SUCTION AND DELIVERY LINES

Instructions for selecting and installing suction and delivery lines, emphasizing correct diameter and secure connections.

M4 CONFIGURATION AND ACCESSORIES

- Wide range of accessories available for the pump, including various hose types, couplings, and adapters.

N CONNECTIONS

- N1 ELECTRICAL CONNECTIONS: Follow correct wiring procedures and safety protocols. N2 CONNECTING THE PIPING: Ensure proper pipe fitting and secure connections.

ENGLISH (Translated from Italian)

I ELECTRICAL SPECIFICATIONS

Table with 4 columns: PUMP MODEL, FUSES, ELECTRICAL POWER SUPPLY, and CURRENT. Lists specifications for different pump models.

L OPERATING CONDITIONS

- L1 ENVIRONMENTAL CONDITIONS: Operating temperature, humidity, and lighting requirements. L2 ELECTRICAL POWER SUPPLY: Voltage and power supply specifications.

L3 DUTY CYCLE

Information regarding the pump's duty cycle, including maximum run times and rest periods.

L4 FLUIDS PERMITTED / FLUIDS NOT PERMITTED

- Permitted fluids: Water, glycol, and other compatible liquids. Prohibited fluids: Flammable, toxic, or corrosive substances.

M INSTALLATION

- M1 PRELIMINARY INSPECTION: Verify all components are present and correct. M2 POSITIONING THE PUMP: Ensure correct orientation and secure attachment.

M3 NOTES ON SUCTION AND DELIVERY LINES

Instructions for selecting and installing suction and delivery lines, emphasizing correct diameter and secure connections.

M4 CONFIGURATION AND ACCESSORIES

- Wide range of accessories available for the pump, including various hose types, couplings, and adapters.

N CONNECTIONS

- N1 ELECTRICAL CONNECTIONS: Follow correct wiring procedures and safety protocols. N2 CONNECTING THE PIPING: Ensure proper pipe fitting and secure connections.

ENGLISH (Translated from Italian)

O INITIAL START-UP

- O1 GETTING STARTED: Initial safety checks and pump priming procedures. O2 INITIAL START-UP: Step-by-step instructions for starting the pump.

P DAILY USE

- P1 FOREWORD: General usage instructions. P2 PROCEDURE: Detailed steps for operating the pump in various modes.

Q MAINTENANCE

- Q1 ONCE A WEEK: Routine maintenance tasks. Q2 ONCE A MONTH: Intermediate maintenance checks. Q3 ONCE A YEAR: Annual maintenance and safety inspections.

R NOISE LEVEL

Information regarding the pump's noise level, including measurement methods and safety precautions.

S PROBLEMS AND SOLUTIONS

Table with 3 columns: Problem, Possible Cause, and Corrective Action. Lists common operational issues and their solutions.

T DEMOLITION AND DISPOSAL

- T1 FOREWORD: Safety instructions for dismantling the pump. T2 DISPOSAL: Proper disposal methods for the pump and its components.

ENGLISH (Translated from Italian)

U ACCESSORIES

- U1 LIST OF ACCESSORIES: Overview of available accessories. U2 BODY ORIENTATION: Instructions for correct pump orientation.

V BODY ORIENTATION

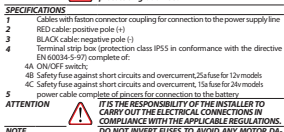

W PIPING

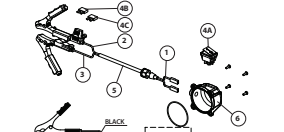

X ELECTRICAL CONNECTIONS

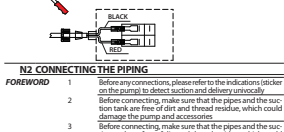

Y SAFETY

- Y1 SAFETY: General safety reminders. Y2 INFORMATION REGARDING THE ENVIRONMENT FOR CLIENTS RESIDING WITHIN THE EUROPEAN UNION: Environmental and disposal instructions.

ENGLISH (Translated from Italian)

Z ADDITIONAL INFORMATION

- Z1 ADDITIONAL INFORMATION: Additional technical details and notes. Z2 CONTACT INFORMATION: Where to find more information or support.

ENGLISH (Translated from Italian)

BY PASS 3000

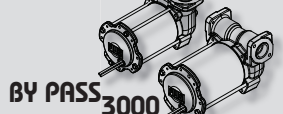

CARRY 3000

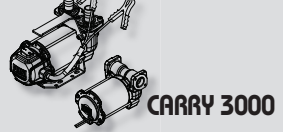

BATTERY KIT 3000



MANUALE D'USO E MANUTENZIONE

Manual title in Italian: MANUALE D'USO E MANUTENZIONE

USE AND MAINTENANCE MANUAL

Manual title in English: USE AND MAINTENANCE MANUAL

Bulletin M0192A1TEN rev. 0

PIUSI logo and slogan: think genius

PIUSI S.p.A. - Suzzara (MO) Italy

Bulletin M0192A1TEN rev. 0

